

EcoFlow DELTA 3 Max Plus

Thank you for choosing our product!



Contents

About This Manual

Overview

Appearance

Display Screen

Error Message

Getting Started

Power On/Off

Power Your Appliances >

Recharge Your Power Station >

Smart Control

EcoFlow App Introduction

App Download Methods

Product Compatibility >

Advanced Features >

Storage and Maintenance >

Safety Instructions and Compliances >

Technical Specifications >

Appendix >

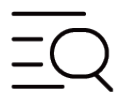

FAQ



EcoFlow App



After-sales
Policy



Community

About This Manual

- This manual contains an introduction to this power station, and details on its operation, management, and maintenance. Please note that this manual may be updated without prior notice.
- The availability of certain accessories and features described in this manual may vary depending on your country or region.
- All images displayed in this manual are for demonstrative purposes only. Please refer to the actual product received. The following examples are based on the US version of EcoFlow DELTA 3 Max Plus.
- If you are reading this manual in PDF format, please note that you can access it online at [EcoFlow Support](#) for a better experience and the latest updates.

Overview

EcoFlow DELTA 3 Max Plus (hereinafter referred to as "DELTA 3 Max Plus", or "the power station") is a power station with a LiFePO₄ battery and a capacity of 2048Wh. It has multiple outputs, including standard AC ports, USB-A ports, USB-C ports, 12V DC ports and Extra Battery port to support various appliances and devices. The variety of charging options allows you to easily switch between different methods based on your actual needs.

Appearance

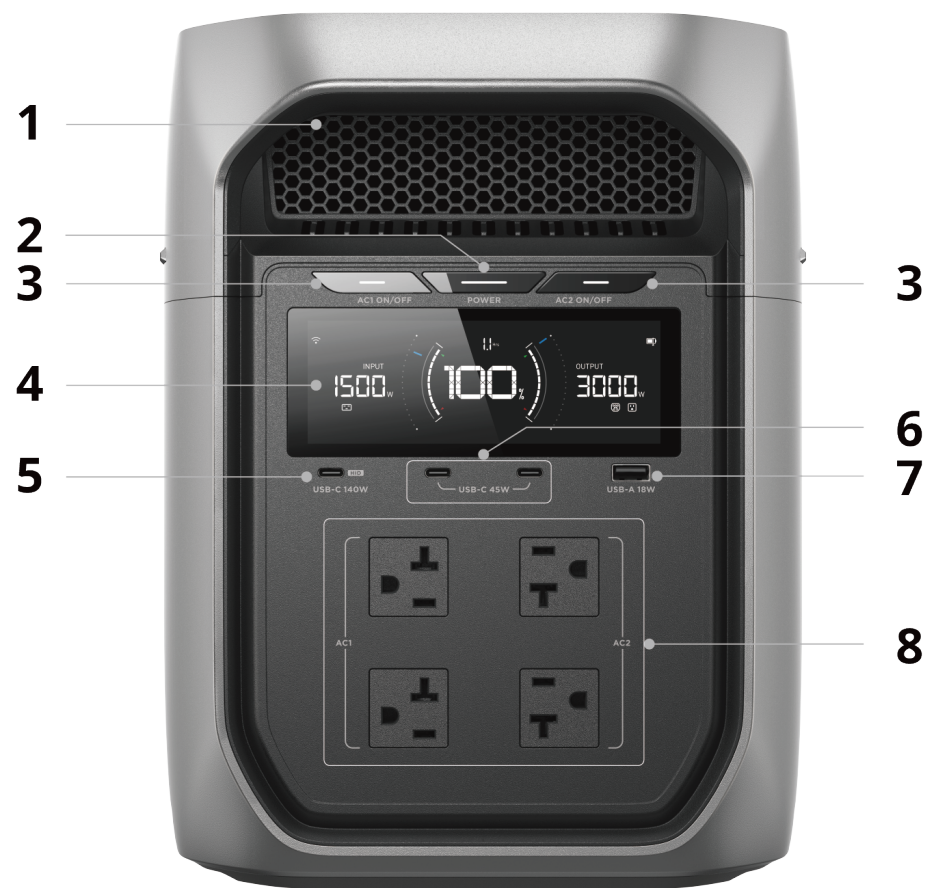

1 Heat Vent

Dissipates the internal heat.

2 Main Power Button

Power on/off

- Press the button once to turn on the power station. Long press the button for 2 seconds to turn it off.

Screen on/off

- After the power station is turned on, press once to turn on or off the display screen.

Reset IoT connections

- While the power station is off, long press the button until the screen displays the power-on animation twice to reset the Bluetooth and Wi-Fi connections.

3 AC1/AC2 Output Control Button

AC Output On/Off

- Press the button once to enable or disable the corresponding power outputs.

Change AC Operating Frequency

- Press and hold the button for 10 seconds to change the AC output frequency.

4 Display screen

Displays operating status.

5 140W USB-C Output Port

Supplies power to charge phones, laptops, game consoles, or other devices.

6 45W USB-C Output Port

Supplies power to charge phones, laptops, game consoles, or other devices.

7 18W USB-A Output Port

Supplies power to charge phones, laptops, game consoles, or other devices.

8 AC Output Sockets

Supplies power to AC loads (household appliances or other equipment). The appearance and specification of AC output and input ports vary according to your local standards.



9 AC Input Socket

Connects the power station to an AC power source (wall outlet or generator) for charging.

10 Charge Speed Switch

ADJUST

- Charge the power station at a custom power level that is defined in the EcoFlow app.

FAST

- Charge the power station at the maximum supported power level.

Note

- Adjustments to the Charge Speed switch are only effective when the power station is being charged via the AC Input Socket.

11 DC/Solar Input Ports

Connects the power station to solar panels or a vehicle power source (cigarette lighter socket or on-board battery charger) for charging.

12 Protective cover

Protects against liquids and dust during long-term storage.

13 Extra Battery Port

DC power supply

- Connects the power station to an EcoFlow smart device to supply power.

DC charging

- Connects the power station to an EcoFlow alternator charger, smart generator, or microinverter for charging.

Battery capacity expansion

- Connects the power station to an EcoFlow Smart Extra Battery to expand the battery capacity.

14 12V DC Output Port (Anderson)

Supplies power to 12V DC loads (automotive refrigerators or other devices).

15 12V DC Output Port (cigarette lighter)

Supplies power to 12V DC loads (routers, security cameras, effects pedals, or other devices).

16 12V DC Output Control Button

Enables or disables the 12V DC output ports.

Display Screen

- i** Icons may be updated to enhance the user experience. Please refer to the actual display.

Function Bar



1 Wi-Fi

On: : The power station is connected to the internet via a wireless network.

Blinking: The power station is connected to a wireless network.

Off: Wi-Fi disconnected.

2 Bluetooth

On: The power station is connected to a Bluetooth device.

Blinking: The power station is in the Bluetooth pairing process.

Off: Bluetooth disconnected.

3 Self-powered mode/Energy management mode

On: The power station is operating in self-powered mode/energy management mode. In self-powered mode, the power station monitors your home's electricity consumption through the smart meter and delivers just the right amount of energy to minimize grid usage.

Off: Exited the self-powered mode/energy management mode.

4 TOU (Time-of-Use) mode

On: The power station is operating in TOU mode. The TOU (Time-of-Use) mode is designed to help you save money on a fluctuating rate plan. It charges your battery when the electricity rate is low and discharges it when the rate is high.

Off: Exited the TOU mode.

5 Scheduled task mode

On: The power station is operating in scheduled task mode. Suitable for those with a fluctuating rate plan and regular power consumption routines. During periods without scheduled tasks, the system will operate in Self-powered mode.

Off: Exited the scheduled task mode. The power station will operate in self-powered mode.

6 Storm guard mode

On: Storm Guard mode activated. The power station will charge to 100% and won't discharge unless there's a grid outage.

Off: Exited storm guard mode. The power station will operate in self-powered mode.

7 Output Port Memory

On: Output Port Memory is enabled. When the power station is turned off, undergoes a firmware upgrade, or reaches the discharging level, it stores the current output state before it powers down. Upon being turned on, completing the firmware upgrade, or exceeding the discharging level, it automatically restores all outputs.

Note: The power station will not restore an output if that output port is automatically turned off due to its standby time or if it is manually turned off by pressing its corresponding control button.

8 Bypass mode disabled

On: Bypass mode is disabled.

Off: Bypass mode is enabled.

9 Fan Status

On: The ventilation fan is running.

Blinking: Abnormal fan status

10 Generator Auto On / Off

On: The automatic start / stop of the connected generator has been set up in the EcoFlow app. This feature is only applicable to an EcoFlow Smart Generator connected to this power station via the Extra Battery port.

11 Adjustable Charging Speed

On: Charge Speed Switch is set to ADJUST. The power station will be charged at the customized speed defined in the EcoFlow app.

12 Charging / Discharging Limit

On: The charge limit or discharge limit is set in the EcoFlow app.

Blinking: The discharge limit is reached. The AC outputs and 12V DC outputs cannot be enabled.

Power Input/Output Details

i A port malfunction is detected when an input/output icon is flashing. Please check the EcoFlow in-app instructions for troubleshooting.

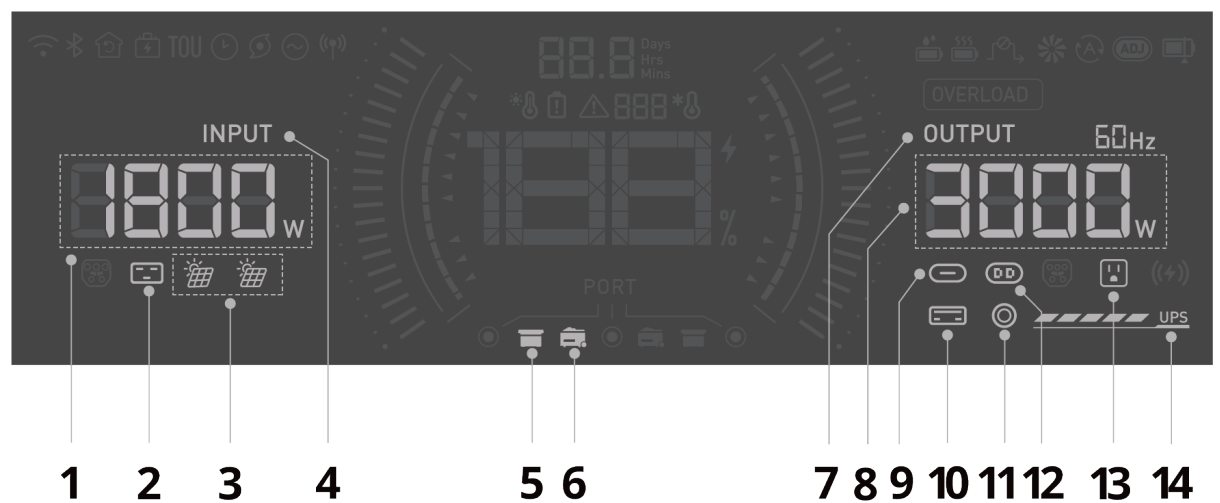

1 Total Input Power

On: Displays total input power.

2 AC Input Socket

On: The socket is physically connected.

Blinking: Port malfunction.

3 PV Input / Car Input

On: The port is physically connected and has power input.

Blinking:

1. Indicates that low light protection has been triggered.
2. Indicates overvoltage or undervoltage.

4 Input Icon

On: Displays power input details.

5 Extra Battery

On: EcoFlow Smart Extra Battery is connected via the Extra Battery port.

6 Smart Generator

On: EcoFlow Smart Generator is connected via the Extra Battery port.

7 Output Icon

On: Displays power output details.

8 Total Output Power

On: Displays total output power.

9 USB-C Output

On: The port is physically connected and has power output.

Blinking: Port malfunction.

10 USB-A Output

On: The port is physically connected and has power output.

Blinking: Port malfunction.

11 Car Output

On: The port is physically connected and has power output.

Blinking: Port malfunction.

Off: The port is physically disconnected and has no power output.

12 12V DC Output

On: The Anderson port is enabled.

Blinking: Port malfunction.

13 AC Output Socket

On: The AC output sockets are enabled.

Blinking: Port malfunction.

14 Automatic Power Switching: Device Backup

On: The power station is connected to the grid and discharges through the bypass circuit. The power bars indicate discharging power capacity.

Off: The icon will disappear once the power grid is back on.

Battery Level Details

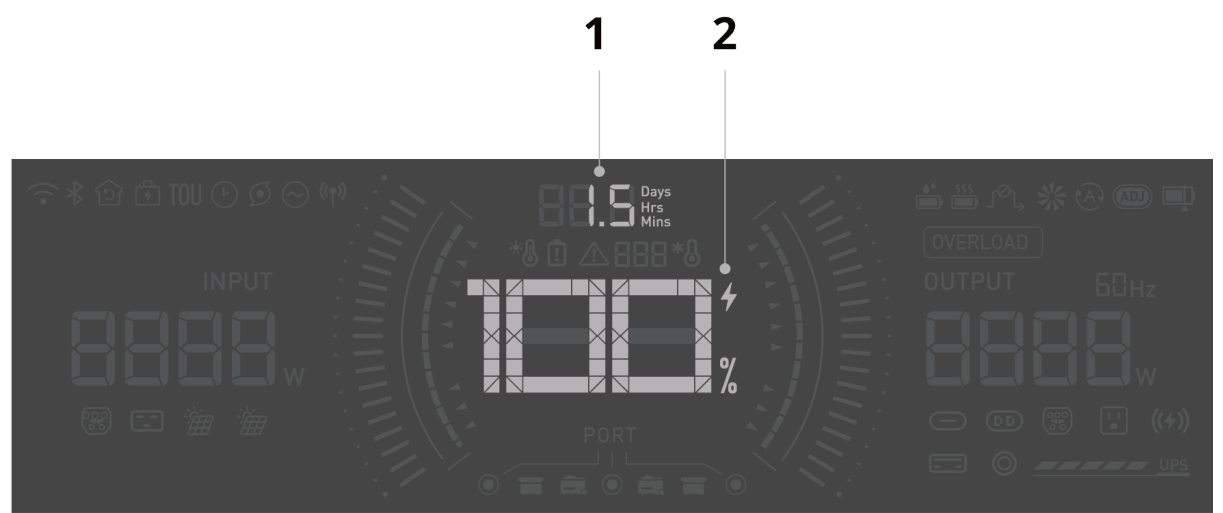

1 Remaining Charging / Discharging time

On: Displays the remaining charging or discharging time.

2 Battery Level

On: Displays current battery level.

Error Message

i If the error message persists after troubleshooting, please stop using the power station immediately. Do not attempt to charge or discharge.

Error Icons

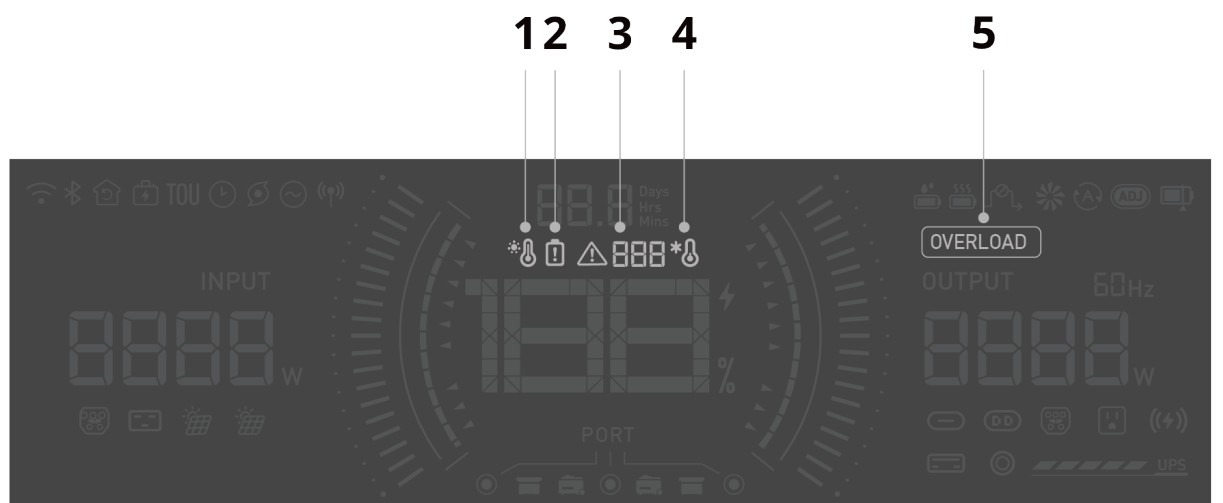

1 High Temperature Warning

Blinking: High temperature protection is triggered. Stop operation and place the power station in a location away from heat sources with good ventilation. The alarm will disappear once the power station temperature returns to normal operating levels.

2 Battery Error

Blinking: An error has occurred. Check the EcoFlow in-app instructions for troubleshooting.

3 Error Code

On: An error has occurred. Check the EcoFlow in-app instructions for

troubleshooting.

4 Low Temperature Warning

Blinking: Low temperature protection is triggered. Move the power station to a warmer location to ensure usage within the appropriate temperature range. The warning will disappear once the power station temperature returns to normal operating levels.

5 Overload Warning

Blinking: Overload protection is triggered. Disconnect some devices from the power station to decrease the overall power output. The warning will disappear once the power output returns to its usual level.

Buzzer

The power station's buzzer **continues to alarm (beep three times per second)** when a severe port malfunction is detected.

Please stop using the power station immediately, remove all input or output connections, and contact EcoFlow Customer Service for troubleshooting.

Getting Started

Power On/Off

- **Power On**

Press the button once to turn on the power station.

- **Power Off**

Press and hold the button for 2 seconds to turn it off.

- **Screen On/Off**

After the power station is turned on, press once to turn on or off the display screen.





The power station can't be turned off via the main power button when it has a charging input. Please unplug the charging cable first.

Power Your Appliances

Via USB Output Ports

Connect your devices to the corresponding ports.

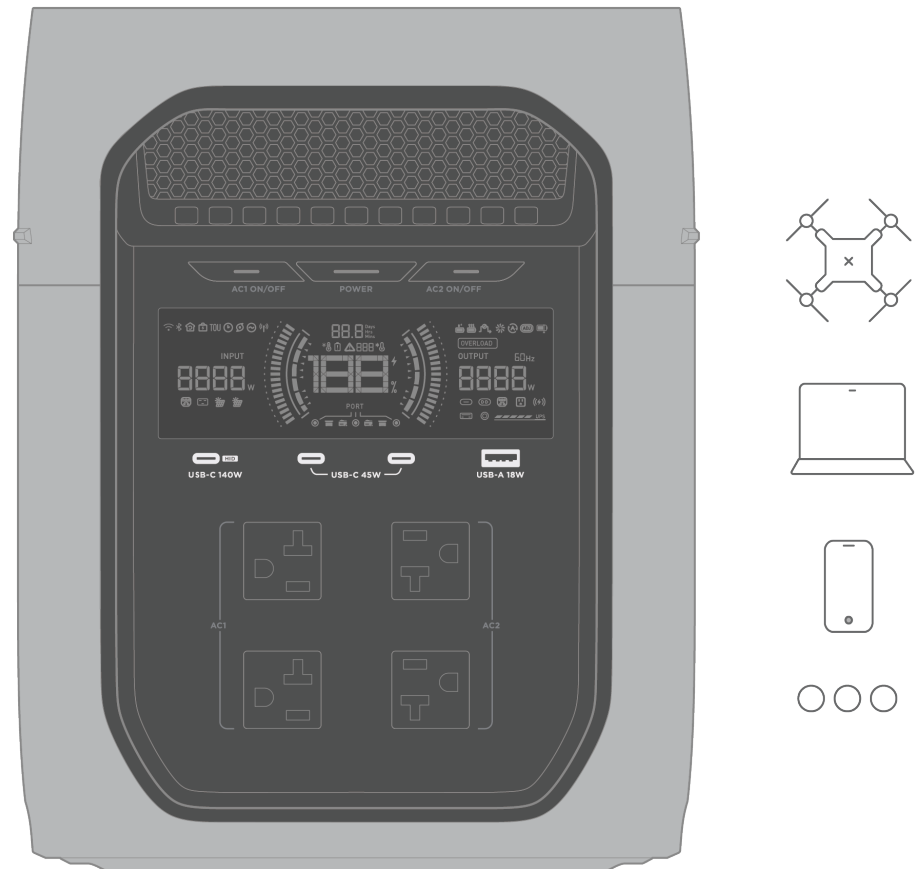

Via 12V DC Output Ports

1. Press the 12V DC output control button once to enable the power supply.
2. Connect your appliances to the corresponding

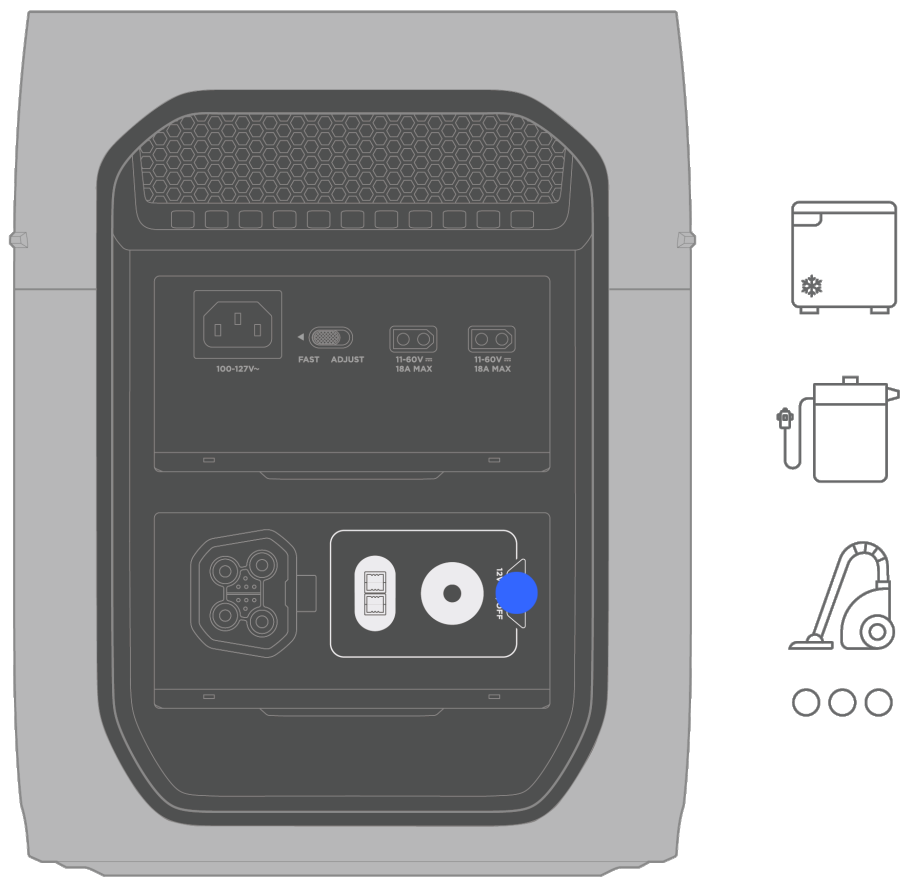

Via AC Output Sockets

1. Press the AC output control button once to enable the power supply.
2. Connect your appliances to the corresponding ports.

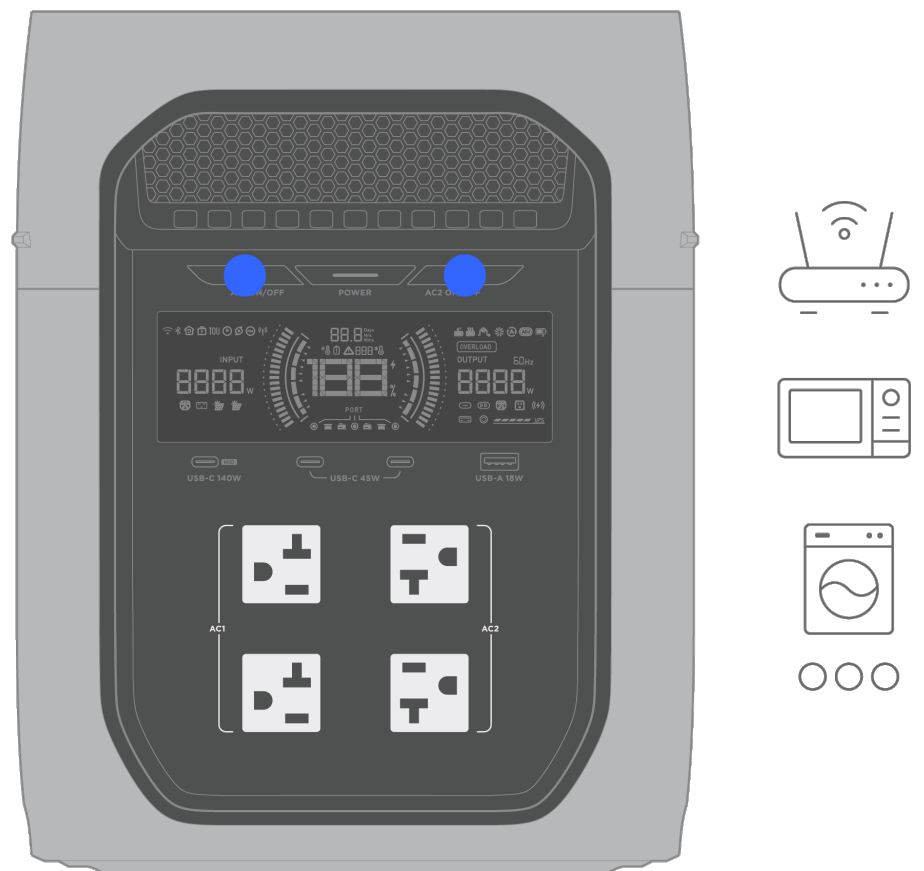



1. AC Operating Frequency: Press and hold the button for 10 seconds to change the AC output frequency for practical usage purposes.
2. AC Timeout Tip: The AC output port of the power station will automatically turn off if the port is idle for a certain period. When the power station is connected to an intermittent load like a refrigerator or air conditioner, this feature may be triggered. If you need to power your device continuously, such as when storing medicines, vaccines, or other valuable items in a refrigerator, set the power station's AC timeout interval to "never" in the EcoFlow app. Additionally, regularly check the power station's battery level.

Recharge Your Power Station

Charging power

When connected to a compatible EcoFlow extra battery, the charging speed can reach up to approximately 2300W.

Charging priority

The power station supports simultaneous connection of multiple input sources via the AC input port, XT60 input port, and the extra battery port, with the following charging priority:

EcoFlow microinverter	via XT150 DC port (EcoFlow Smart Generator Adapter required)
Solar power	via XT60 DC port
AC power	via AC input port, including grid power and generator
EcoFlow smart generator	via XT150 DC port (EcoFlow Smart Generator Adapter required)
EcoFlow alternator charger	via XT150 DC port (EcoFlow Smart Generator Adapter required)

The above charging priority logic may be updated with product revisions. Clean and stable power sources are generally used by default.

From the Wall Outlet

Connect the power station's AC input socket to a wall outlet using the provided AC charging cable.

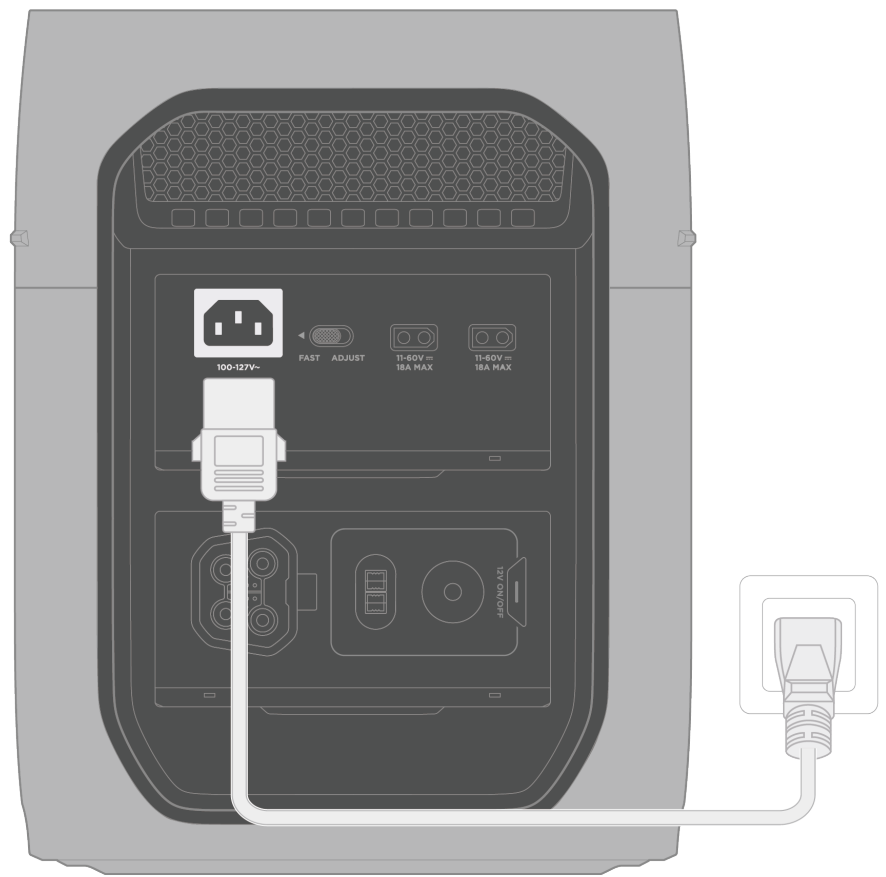

From the Solar

The power station has 2 XT60i input ports which support both solar charging and car charging. Here is a basic guiding principle that helps you check your setup, when connecting your solar panel(s) to charge the power station:

1. Connect this port to solar panel(s) using an EcoFlow Solar to XT60i Charging Cable.
2. Please make sure that the total Voc (open circuit voltage) of the solar panel(s) is within 60V, and the total Isc (short circuit current) is within 18A to avoid product damage.
3. For series or parallel connection, please refer to the solar panel's manual for more details.

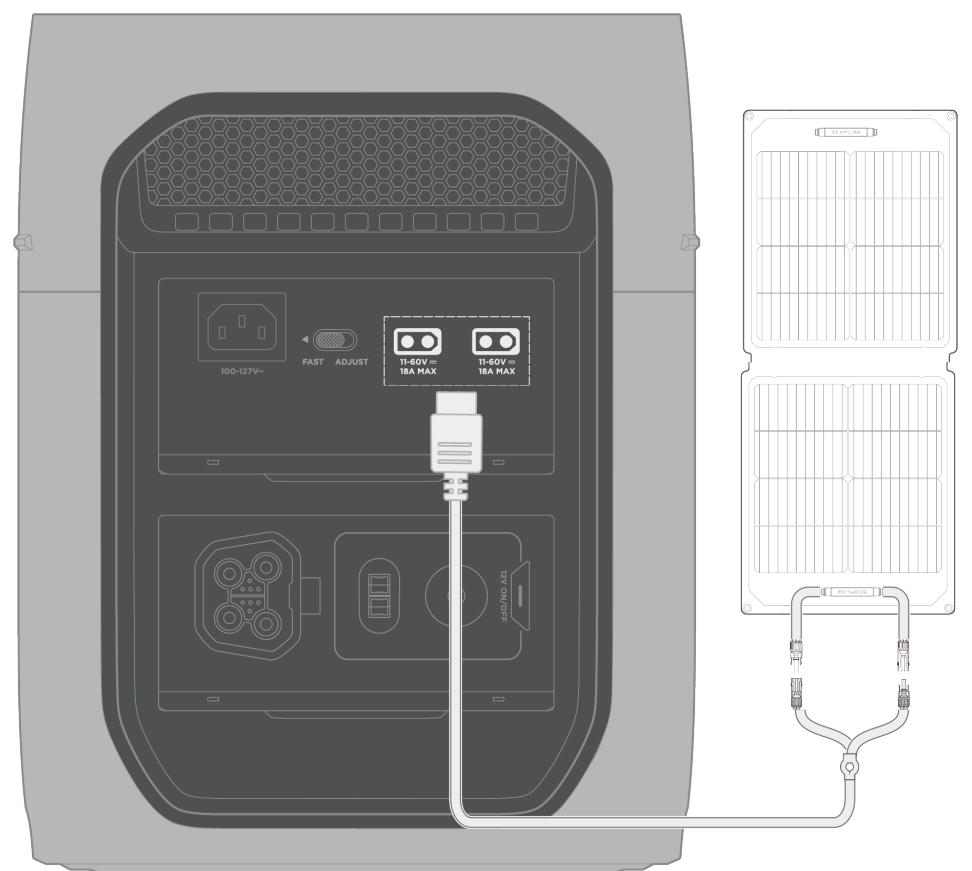

From the Car

The power station has 2 XT60i input ports which support both solar charging and car charging.

Please connect the power station's car charging input port to your vehicle's cigarette lighter socket using a car charging cable (sold separately).

* To avoid the start failure due to an insufficient car battery, please connect the charging cable after the vehicle is started. In addition, please make sure that the cable is securely connected to the cigarette lighter.

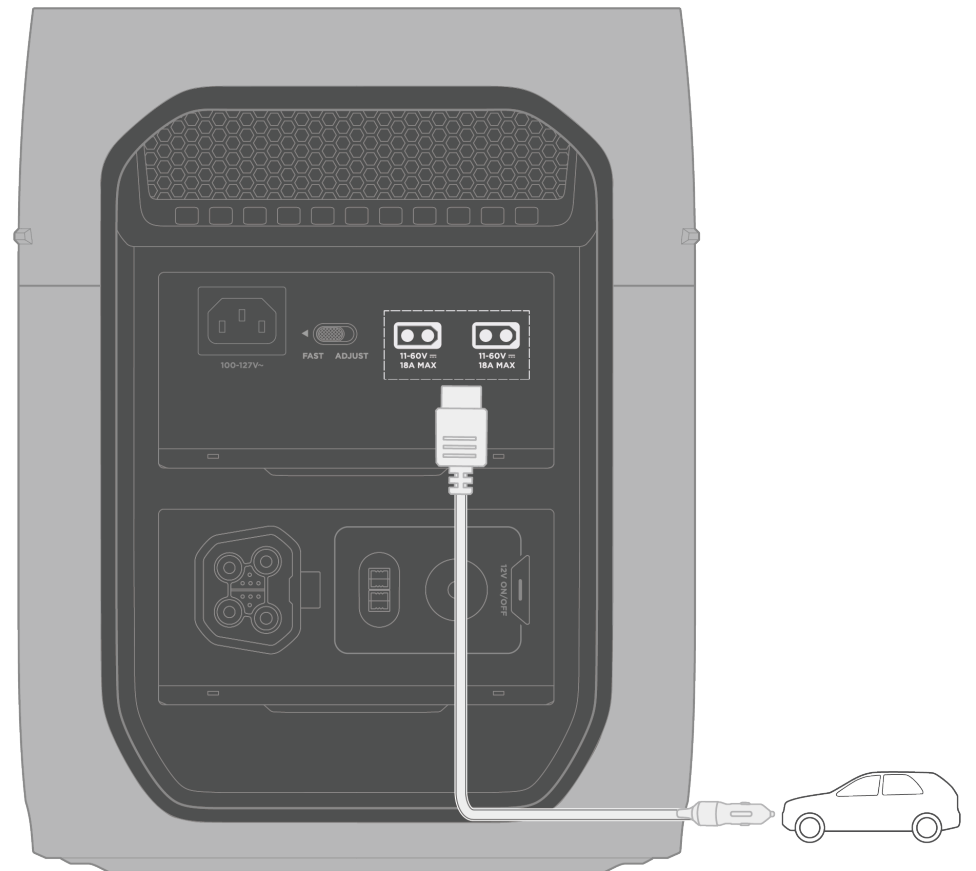

From a Generator

Method 1: via the AC Input Socket

Connect the power station's AC Input socket to a generator using the AC charging cable provided.

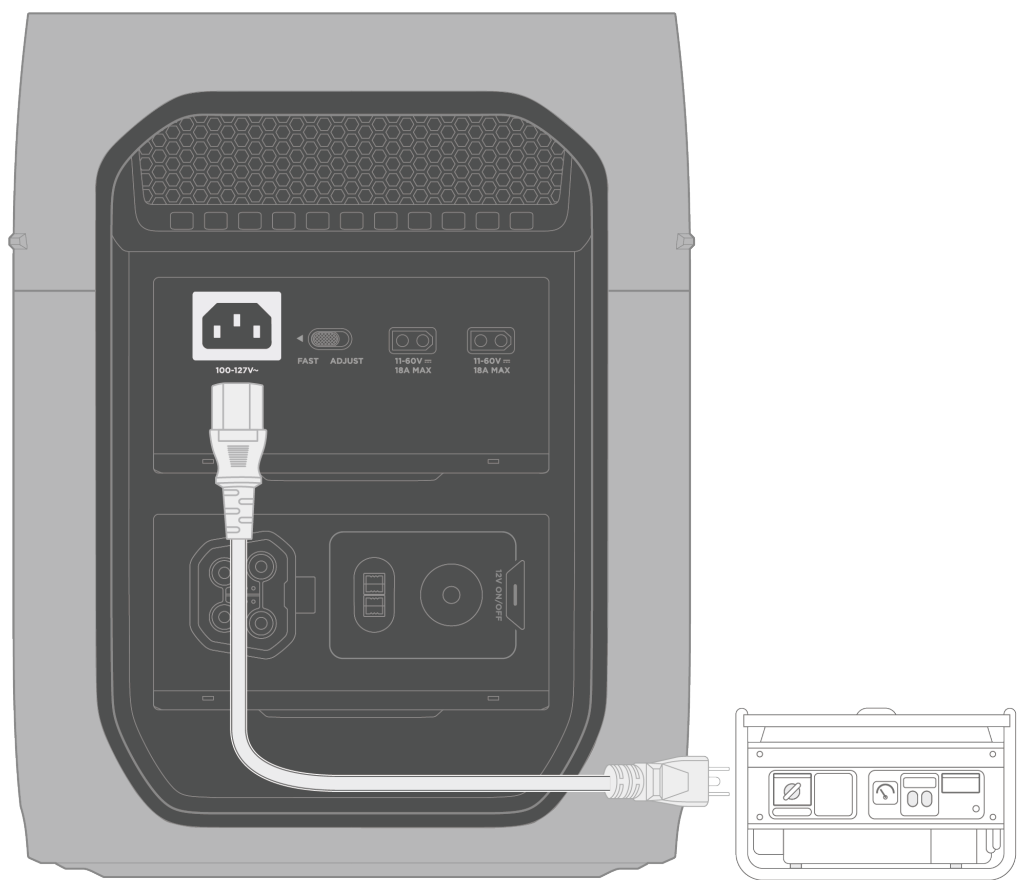

Method 2: via the Extra Battery Port (Only Supports EcoFlow Smart Generators)

1. Install the Smart Generator Adapter into the power station's Extra Battery port.
2. Connect the power station to an EcoFlow generator's XT150 port using the EcoFlow extra battery cable.

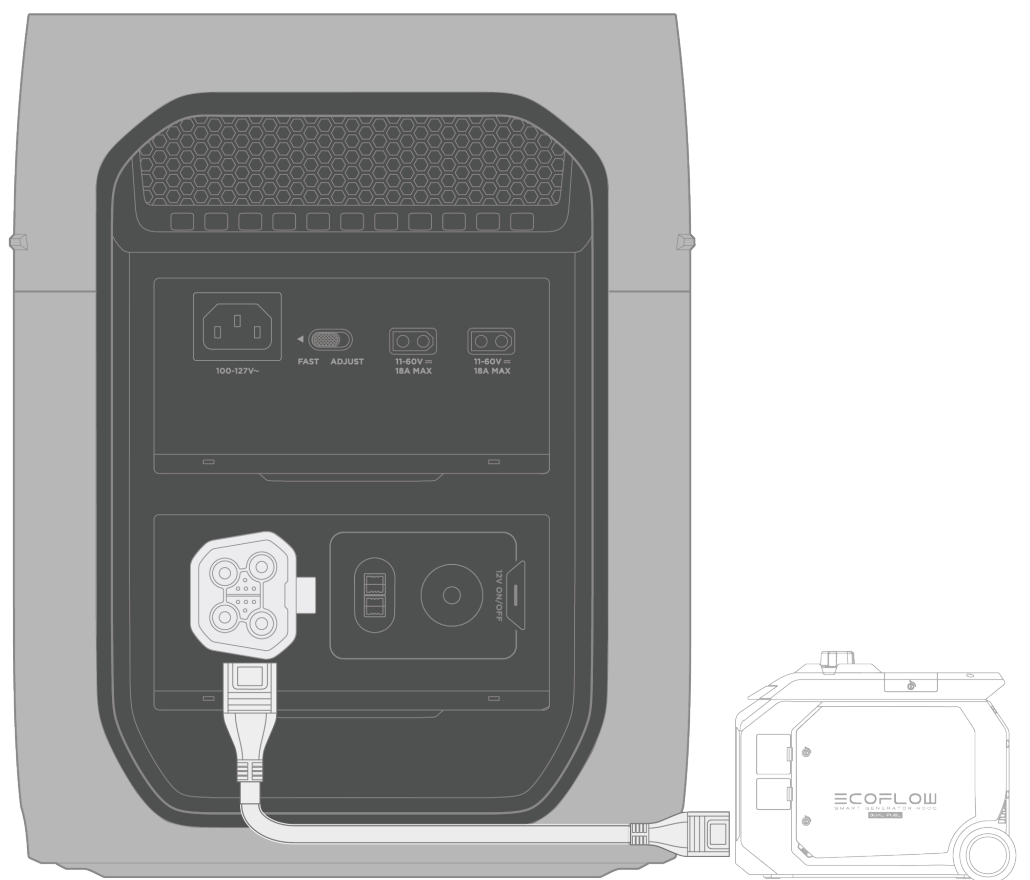

From EcoFlow Microinverter

Connect the power station to the microinverter using the **EcoFlow BKW-DELTA EB Cable** (sold separately).

Adding a power station to your PowerStream system allows you to use solar energy day and night and reduce energy bills.

View more →

From EcoFlow Alternator Charger

Connect the power station to the portable power station port of the alternator charger using the **XT150 output cable**.

View more →

Smart Control

EcoFlow App Introduction

EcoFlow offers a companion app for device management. With this mobile application, you can:

- Enjoy all-in-one control of your EcoFlow devices from anywhere.
- Monitor power consumption details seamlessly with real-time updates.
- Personalize your energy scheme with an array of customizable options.
- Promptly receive in-app troubleshooting and firmware updates.

App Download Methods



Scan the QR code or download it at:

<https://download.ecoflow.com/app>

- Method 1: Scan the QR code to download.
- Method 2: Search for "EcoFlow" in the iOS or Android App Store.
- Method 3: Visit <https://download.ecoflow.com/app> to download.



The EcoFlow app continuously adapts to enhance the user experience and functionality. Screenshots in this manual are for demonstration purposes only. The actual appearance may vary depending on the app version and operating system. This manual does not cover every detail of the app's functions, and users are encouraged to explore the app themselves.

Register and Log In

To Register an Account:

1. Open the EcoFlow app and tap Create new account.
2. Enter the required registration information, then tap Sign up. The email address you entered will be used as your EcoFlow account.

To Log In

1. Open the EcoFlow app and tap Log in.

2. Enter your registered email address and password, and proceed to access the device management page.

Bind the Device and Set Up the Internet

When you first set up a new device, bind it to your EcoFlow account to ensure remote access to the device's settings.

To bind a new EcoFlow device/system:

1. Visit the EcoFlow app and log into your EcoFlow account.
2. Tap the Add Device button or + icon in the top right corner to search for new EcoFlow devices.
3. Select your EcoFlow device and follow the pop-up instructions to complete device binding and Wi-Fi setup.

Access Device Management

With the EcoFlow app, you can manage all your bound devices via phone. The power station supports Wi-Fi and Bluetooth connections, adapting to different network conditions to ensure convenient access to device settings.

- **With Internet**

When Wi-Fi is stable, you can access the device settings via the internet. This method is always recommended to ensure your EcoFlow device can receive timely firmware updates and pushes.

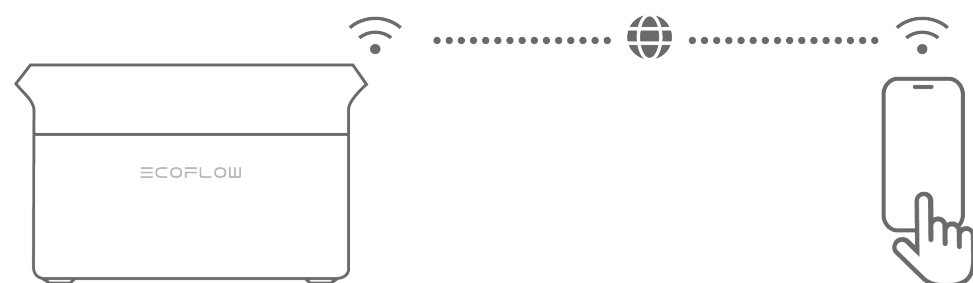

- **Without Internet**

If the Wi-Fi connection is unavailable, you can manage the device locally via Bluetooth, though some settings may be restricted.

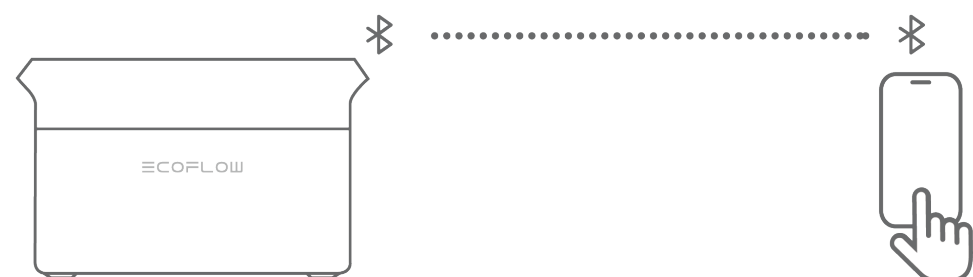

Key Functions

Space

During the device binding process, you can assign the device to a new or existing Space. The Space serves as the homepage that displays the status of all assigned EcoFlow devices. You can customize multiple Spaces based on your device type or usage scenarios.

- To manage Space
Tap the space name in the top left corner, then select Space Management to add, edit, or delete space.
- To switch Between Spaces
Tap the space name to open the dropdown list, then select a space to switch to its homepage view.
- To view Space status
Tap the top component to view the total data for the Space page, including details about input/output, operating temperature, real-time battery level, and more.

Product Compatibility

EcoFlow Smart Extra Battery

Name	Model
EcoFlow DELTA 3 Max Plus Smart Extra Battery	EFD3MP-EB
EcoFlow DELTA 3 Smart Extra Battery	EF-DL-E10-4
EcoFlow DELTA Pro 3 Smart Extra Battery	EFD521-EB
EcoFlow DELTA 2 Max Smart Extra Battery	EFD350-EB

Other EcoFlow Products

- Click on the product name to view the corresponding user manual.

Name	Model
EcoFlow WAVE 2 Portable Air Conditioner	EFKT210
EcoFlow PowerStream Microinverter	EFWN511, EFWN511B
EcoFlow 800W Alternator Charger	EF-FC-301-1
EcoFlow Smart Generator 3000 (Dual Fuel)	EF-SG-H03-1 (charging only)
EcoFlow Smart Generator 4000 (Dual Fuel)	EF-SG-H01-1 (charging only)
EcoFlow GLACIER Classic)	EF-GC-H-35/45/55
EcoFlow WAVE 3 Portable Air Conditioner)	EF-WA-H01-3

Advanced Features

Expand Battery Capacity

If you frequently encounter power-intensive scenarios or require prolonged usage during power outages, you can proactively install extra battery capacity.

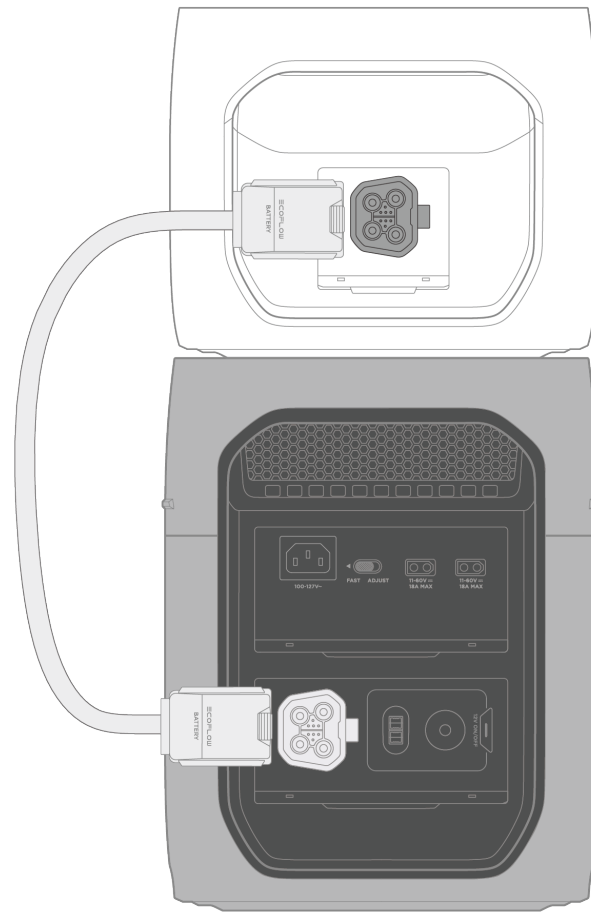

1. Connect the extra battery to the power station's Extra Battery port.
2. The extra battery is considered successfully installed once the battery icon is displayed on the screen of the power station.

X-Boost: Power the High-Wattage Appliances

X-Boost is an innovative technology exclusive to EcoFlow power stations. It allows the power station to support appliances with a higher power requirement than its rated power output.

How do I use this feature?

X-Boost is enabled by default. It can be adjusted in the device settings of the EcoFlow app.

What kind of devices does X-Boost support?

- X-Boost is more suitable for heating devices, such as an electric blanket, a water heater, or a heat pump.
- X-Boost does not support devices with voltage protection (such as precise instruments). Connecting such devices may cause them to stop working due to low voltage.



Note:

X-Boost is unavailable when the power station is being charged via an AC power source (e.g. when the power station is in bypass mode).

Reference: Power with X-Boost Feature

Versions	Rated Power	Power with X-Boost
----------	-------------	--------------------

US	3000W	3800W
JP	3000W	3800W
BR_LV	3000W	4300W
CN	3000W	3600W
KR	3000W	3600W
BR_HV	3000W	3600W
CH	3000W	3900W
AU	3000W	3900W
EU	3000W	3900W
UK	3000W	3900W
ZA	3000W	3900W
INT	3000W	3900W

Automatic Power Switching: Device Backup

This portable power station is equipped with a feature that automatically switches the power supply for connected devices from the grid to the unit during a power outage, helping to minimize power interruption.

How do I use this feature?

1. Connect the power station to a wall outlet to access grid power.
2. Connect any appliances to this power station so the power station can provide them with power to operate during a power outage.





Note

In this setup, the power station should draw more power from the grid than it delivers to connected loads. The excess power is used to charge and maintain the internal batteries. If the input power is insufficient, the batteries may not charge properly, and the power station may fail to operate reliably as a backup power source.

Storage and Maintenance

Storage

- Store the device in an environment between -10°C and 45°C , with a recommended range of approximately 0°C to 30°C to maintain battery health.
- Keep the product in a dry, cool, well-ventilated area that is secure and reduces the risk of falling.
- Ensure the device is kept away from water sources, heat sources, strong magnetic fields, environments with corrosive gases, and any flammable or explosive substances.
- For long-term storage, charge and discharge the product once every 3 months (fully charge it, then discharge to 60% for storage) to maintain battery health.
- Do not leave the device uncharged or unused for more than 6 months; otherwise, the warranty will be void.

Cleaning

Use a soft, dry cloth to wipe and clean the product.

Maintain Battery Health

- Avoid leaving the product unused for extended periods of time.
- Charge and discharge the product every 3 months to increase its lifespan.

Safety Instructions and Compliances

Disclaimer

This product includes essential printed documentation required for setup and basic usage. For detailed manuals, resources, and the most up-to-date information about the product, visit

<https://www.ecoflow.com/support/download>. Fully read and understand the product documentation prior to use. Improper use may result in serious injury, damage, or property loss. By using this product, you agree to and accept all terms outlined in the product documentation. EcoFlow is not liable for losses,

damages, or injuries caused by misuse or non-compliance.

Operation

1. Do not disassemble, repair, or modify this product by yourself. For any maintenance or service, please contact EcoFlow Customer Service.
2. Always disconnect the product from all external power sources before attempting any service or maintenance.
3. To reduce risk of damage to the electric plug and cord, pull the plug rather than the cord when disconnecting the product.
4. Do not pierce the product with sharp objects.
5. Do not put fingers or hands into the product.
6. Do not insert wires or other metal objects into the product to prevent short circuits.
7. Do not block or restrict the heat dissipation system of the product during operation.
8. Do not use any unofficial or unrecommended components or accessories. For any replacements, please contact EcoFlow for further assistance.
9. Do not operate this product with a damaged cord or plug, or a damaged output cable.
10. Ensure that the cable length for each DC connection to this product is less than 3 meters.
11. Do not stack any heavy objects on the product.
12. Place the product on a stable and flat surface. Avoid damage to the device or personal injury due to the product falling or tipping over.
13. Use a soft, dry cloth to wipe and clean the product.
14. AC Timeout Tip: The AC output port of the power station will automatically turn off if the port is idle for a certain period. When the power station is connected to intermittent loads like refrigerators or air conditioners, this feature may be triggered. To ensure continuous power supply for critical uses, such as storing medicines, vaccines, the perishables, or other valuable items in a refrigerator, set the power station's AC timeout interval to never in the EcoFlow app. Additionally, regularly check the power station's battery level.
15. Medical Equipment Limit: The product is not intended for powering life-sustaining medical equipment, including but not limited to medical-grade ventilators (hospital-grade CPAP: Continuous Positive Airway Pressure) or artificial lungs (ECMO: Extracorporeal Membrane Oxygenation). If you plan to use it for other medical equipment, consult with the equipment's manufacturer first to ensure there are no restrictions on using an external power source with their equipment.
16. Medical Equipment Interference: When in use, power supply products will generate electromagnetic fields, which are likely to affect the normal operation of medical implants or personal medical equipment such as

pacemakers, cochlear implants, hearing aids, defibrillators, etc. If these types of medical equipment are being used, please contact the manufacturer to inquire about any restrictions on the use of such equipment. These measures are fundamental to ensure a safe distance between the medical implants (for example, pacemakers, cochlear implants, hearing aids, defibrillators, etc.) and this product while in use.

17. The plug of the charging cable included in the package is a disconnecting device, and the wall outlet to which it is connected must be easily accessible and well grounded.
18. Electrical appliances connected to this product must comply with local certification requirements, and Type-C ports are only permitted for appliances with fireproof enclosures.
19. Risk of Electric Shock: Never use the product to supply power tools to cut or access live parts or live wirings, or materials that may contain live parts or live wirings inside, such as building walls, etc.
20. Use in Repair Facility: During use in a repair facility like a vehicle repair center, workshop, or any other place where repairs are conducted, do not place the product on the floor, or at a height less than 457 mm (18 inches) above the floor.
21. GROUNDING INSTRUCTIONS: This product must be grounded. If it should malfunction or breakdown, grounding provides a path of least resistance for electric current to reduce the risk of electric shock. For your safety, EcoFlow provides a cord with an equipment grounding conductor and a grounding plug. The plug must be plugged into an outlet that is properly installed and grounded in accordance with all local codes and ordinances. **WARNING** – Improper connection of the equipment grounding conductor can result in a risk of electric shock. If you encounter the following situations, consult a qualified electrician instead of modifying the plug provided with the product:
 - You are unsure whether the product is properly grounded;
 - You find that the plug provided with the product does not fit the outlet.
22. To prevent the product from falling, do not lift it using only one of the side handles.

Storage

1. Follow the environment temperature requirements specified in the product specification to use or store the product. Avoid degradation or damage to the product, or risks to personal safety due to excessively high or low temperatures.
2. Do not use the product near a heat source, such as a fire source or a heating furnace.
3. Do not get the product wet or immerse it in any liquid. When using the product in wet environments like rainy areas or places near water, protect it with a waterproof bag.
4. Do not use the product in an environment with strong static electricity or magnetic fields.
5. Keep the product out of reach of children and pets. If the product is to be used near children, they should be closely supervised.

6. Keep the product away from fumes, smoke, steam, and dust.
7. Store the product in a tidy, dry, and well-ventilated place.
8. Do not carry the product onto a plane.
9. Do not subject the product to severe impacts, vibrations, or drops.

In Case of Emergency

1. In case of emergency, take precautions against electric shock before touching the product, such as wearing insulating gloves.
2. If the product gets wet, stop using it immediately and refrain from further operation or powering it on. Place the product in a secure, waterproof, and well-ventilated area, then contact EcoFlow Customer Service for assistance.
3. If the product falls into water, place it in a secure, waterproof, and well-ventilated area, and keep it away from contact until it is completely dry. The dried product should not be used again and must be properly disposed of according to local laws and regulations.
4. If the product catches fire, we recommend that you use the fire extinguishers in the following order: water or water mist, sand, fire blanket, dry powder, and finally a carbon dioxide fire extinguisher.
5. If the product is overturned and severely damaged, wear insulating gloves to turn it off, and then place the product in an open area far from flammable materials and people, and dispose of it according to local laws and regulations.

Recycling and Disposal

1. The product with severe damage, malfunction, or depleted battery life should be properly disposed of or recycled.
2. The product contains batteries. Please dispose of the product following local laws and regulations for battery disposal and recycling. Do not dispose of it with household waste to avoid environmental pollution and safety hazards.
3. If possible, ensure the battery is completely discharged (to 0% capacity) before disposing of the product. If not, refrain from placing the battery directly into a battery recycling box. Instead, contact a professional battery recycling company for proper handling.

Regulatory Compliance

FCC Compliance Statement

Any changes or modifications not expressly approved by the party responsible for compliance could void the user's authority to operate the equipment.

This device complies with part 15 of the FCC Rules. Operation is subject to the following two conditions:

- (1) this device may not cause harmful interference, and
- (2) this device must accept any interference received, including interference that may cause undesired operation.

Note: This equipment has been tested and found to comply with the limits for a Class A digital device, pursuant to part 15 of the FCC Rules. These limits are designed to provide reasonable protection against harmful interference when

the equipment is operated in a commercial environment. This equipment generates, uses, and can radiate radio frequency energy and, if not installed and used in accordance with the instruction manual, may cause harmful interference to radio communications. Operation of this equipment in a residential area is likely to cause harmful interference, in which case the user will be required to correct the interference at their own expense.

This equipment complies with FCC radiation exposure limits set forth for an uncontrolled environment.

This equipment should be installed and operated with a minimum distance of 20 cm between the radiator & your body.

INDUSTRY CANADA COMPLIANCE

This device complies with Industry Canada licence-exempt RSS standard(s).

Operation is subject to the following two conditions:

(1) this device may not cause interference, and

(2) this device must accept any interference, including interference that may cause undesired operation of the device.

This Class A digital apparatus complies with Canadian ICES-003.

CAN ICES-003(A)

IC RF Statement

When using the product, maintain a distance of 20 cm from the body to ensure compliance with RF exposure requirements.



The Bluetooth® word mark and logos are registered trademarks owned by Bluetooth SIG, Inc. and any use of such marks by EcoFlow Inc. is under license. Other trademarks and trade names are those of their respective owners.



CE

Hereby, EcoFlow Inc. declares that the radio equipment type portable power station is in compliance with Directive 2014/53/EU. The full text of the EU Declaration of Conformity is available at the following Internet address:

EU: <http://www.ecoflow.com/eu/eu-compliance>

DE: <http://www.ecoflow.com/de/eu-compliance>

FR: <http://www.ecoflow.com/fr/eu-compliance>

UK: <http://www.ecoflow.com/uk/eu-compliance>



WEEE

This marking indicates that this product should not be disposed of with other household waste within the EU. Recycle this product properly to prevent possible damage to the environment or a risk to human health via uncontrolled waste disposal and in order to promote the sustainable reuse of material resources. Please return your used product to an appropriate collection point or contact the retailer where you purchased this product. Your retailer will accept used products and return them to an environmentally-sound recycling facility.

For information on the disposal of electrical and electronic equipment, please visit the following website:

<https://eu.ecoflow.com/pages/electronic-devices-disposal>

Technical Specifications

General	
Model	EF-DL3-MP
Net. Weight	Approx. 22.1 kg (48.7 lbs)
Dimensions (W x D x H)	Approx. 494 x 242 x 305 mm (19.4 x 9.5 x 12.0 in)
Wi-Fi (2.4G)	Supported
Bluetooth	Supported
Operating Altitude	< 3000 m
Overvoltage Category	II
Pollution Degree	2
IP Rating	IP20
Output	
AC Output (Discharge Only)	<p>US: 120V~60Hz 3000W total (surge 6000W), 20A(x4) Max per port</p> <p>JP: 100V~60Hz 3000W total (surge 6000W), 20A(x4) Max per port</p> <p>BR_LV: 127V~60Hz 3000W total (surge 6000W), 20A(x4) Max per port</p> <p>CN: 220V~50Hz 3000W total (surge 6000W), 13.6A(x1) Max per port, 10A(x3) Max per port</p> <p>UK: 230V~50Hz 3000W total (surge 6000W), 13A(x4) Max per port</p> <p>EU: 230V~50Hz 3000W total (surge 6000W), 13A(x4) Max per port</p> <p>KR: 220V~60Hz 3000W total (surge 6000W), 13.6A(x4) Max per port</p> <p>BR_HV: 220V~60Hz 3000W total (surge 6000W), 13.6A(x4) Max per port</p> <p>AU: 230V~50Hz 3000W total (surge 6000W), 13A(x4) Max per port</p> <p>CH: 230V~50Hz 3000W total (surge 6000W), 10A(x2) Max per port, 13A(x2) Max per port</p> <p>ZA: 230V~50Hz 3000W total (surge 6000W), 13A(x2) Max per port, 13A(x2) Max per port</p> <p>INT: 230V~50Hz 3000W total (surge 6000W), 13A(x4) Max per port</p>
	<p>US: 100-120V~50/60Hz 3000W total, 20A(x4) Max per port</p> <p>JP: 100-120V~50/60Hz 3000W total, 20A(x4) Max per port</p> <p>BR_LV: 100-127V~50/60Hz 3000W total, 20A(x4) Max per port</p> <p>CN: 220-240V~50/60Hz 3000W total, 13.6A(x1) Max per port, 10A(x3) Max per port</p>

AC Output (Bypass Mode)	UK: 220-240V~50/60Hz 3000W total, 13A(x4) Max per port EU: 220-240V~50/60Hz 3000W total, 13A(x4) Max per port KR: 220-240V~50/60Hz 3000W total, 13.6A(x4) Max per port BR_HV: 220-240V~50/60Hz 3000W total, 13.6A(x4) Max per port AU: 220-240V~50/60Hz 3000W total, 13A(x4) Max per port CH: 220-240V~50/60Hz 3000W total, 10A(x2) Max per port, 13A(x2) Max per port ZA: 220-240V~50/60Hz 3000W total, 13A(x2) Max per port, 13A(x2) Max per port INT: 220-240V~50/60Hz 3000W total, 13A(x4) Max per port
----------------------------	--

USB Output Port	USB-A (x1): 5V=3A / 9V=2A / 12V=1.5A, 18W Max USB-C (x1): 5V=3A / 9V=3A / 12V=3A / 15V=3A / 20V=5A / 28V=5A, 140W Max USB-C (x2): 5V=3A / 9V=3A / 12V=3A / 15V=3A / 20V=2.25A, 45W Max per port, total 45W
-----------------	---

12V DC Output Port	12.6V=30A, 378W Total Anderson Port: 30A Max Cigarette Lighter Port: 10A Max
--------------------	--

Input

AC Input (Charge Only)	US: 100-120V~15A 50/60Hz JP: 100-120V~15A 50/60Hz BR_LV: 100-127V~10A 50/60Hz CN: 220-240V~10A 50/60Hz UK: 220-240V~10A 50/60Hz EU: 220-240V~10A 50/60Hz KR: 220-240V~10A 50/60Hz BR_HV: 220-240V~10A 50/60Hz AU: 220-240V~10A 50/60Hz CH: 220-240V~10A 50/60Hz ZA: 220-240V~10A 50/60Hz INT: 220-240V~10A 50/60Hz
---------------------------	---

AC Input (Bypass Mode)	US: 100-120V~15A 50/60Hz JP: 100-120V~15A 50/60Hz BR_LV: 100-127V~10A 50/60Hz CN: 220-240V~10A 50/60Hz UK: 220-240V~10A 50/60Hz EU: 220-240V~10A 50/60Hz KR: 220-240V~10A 50/60Hz BR_HV: 220-240V~10A 50/60Hz AU: 220-240V~10A 50/60Hz CH: 220-240V~10A 50/60Hz ZA: 220-240V~10A 50/60Hz INT: 220-240V~10A 50/60Hz
---------------------------	---

DC/Solar Input	Solar: 11V-60V=18A Max DC: 12V=8A Max, 24V=8A Max, 48V=10.4A Max
----------------	---

Battery Info

Rated Capacity	2048Wh 51.2V= 40Ah
----------------	--------------------

Cell

Chemistry LFP (LiFePO4)

Protection Type Over Voltage Protection, Overload Protection, Over Temperature Protection, Short Circuit Protection, Low Temperature Protection, Low Voltage Protection, Overcurrent Protection

Extra Battery Port (Input) 43.2V-57.6V==93A Max

Extra Battery Port (Output) 43.2V-57.6V==46A Max

Environment Temperature

Optimal Operating Temperature 20°C-30°C (68°F-86°F)

Charge Temperature 0°C-45°C (32°F-113°F)

Discharge Temperature -10°C to 45°C (14°F-113°F)

Storage Temperature -10°C~45°C (optimal: 20°C~30°C) 14°F to 113°F (optimal: 68°F to 86°F)

Appendix

What's in the Box



1. EcoFlow DELTA 3 Max Plus portable power station ×1
2. AC charging cable ×1
3. Manuals and warranty card



If any item is damaged or missing, contact EcoFlow Customer Service for assistance.

Accessory List

[View More →](#)